

## AC1812LA 12"+18" Subwoofer

AC1812LA is a passive driven high performance cardioid subwoofer powered by a single amplifier channel. Unit configuration: 1×18" driver in a bass-reflex design facing to the front and 1×12" driver in bandpass design radiating to the rear. The cardioid dispersion characteristics resulting from this arrangement avoids unwanted energy behind the system reduces the excitation of the reverberant field at low frequencies and provides the greatest accuracy of low frequency reproduction. It 's convenient for Hanging, stacking, and supporting. The wood box adopts multiayer composite plywood, wear-resistant and waterproof polyurea paint.



### Features

- High-quality unit configuration, cardioid passive subwoofer
- Various combinations: hanging, stacking, supporting, quick installation
- Multi-purpose hall, club, conference centers
- Big scale performance, Stadiums and Odeums
- Can match AC210LA

### Overall dimensions

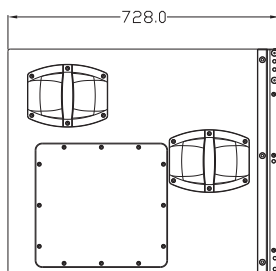
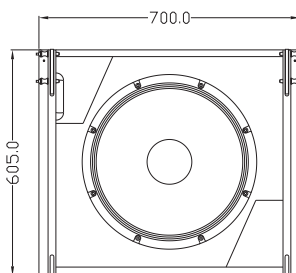

### Technical specifications:

FREQUENCY RESPONSE	40Hz-110Hz
DRIVERS	1×18"(460mm)/4" voice coil LF
DRIVERS	1×12"(300mm)/3" voice coil LF
RATED POWER	2000W RMS,8000W peak
SENSITIVITY	99dB 1watt/1 metre
MAXIMUM SPL	128 dB continuous,134 dB peak
IMPEDANCE	6 ohms nominal
INPUT CONNECTORS	2×Speakon NL4
DIMENSIONS	(W)700mm×(D)728mm×(H)605mm
NET WEIGHT	68.5 kg

